

AB - D SERIES

SHORT PULSE WIDTH LASERS TO MINIMISE THERMAL IMPACT
ON DELICATE SUBSTRATES

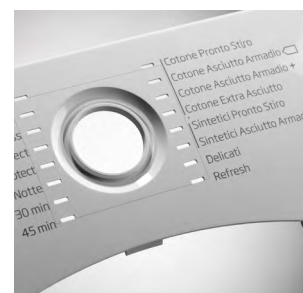

AB - D SERIES

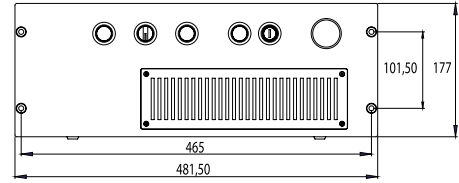
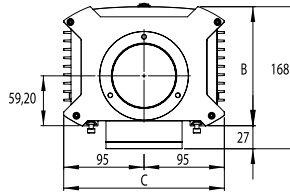
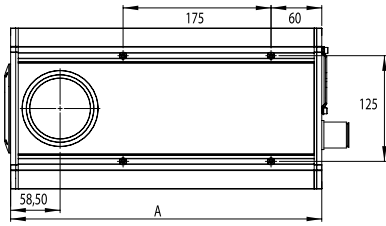

AB-D										
MODEL		AB-N				AB-D				
POWER		6W		20W		6W		20W		
WAVELENGTH		1.064 μm				1064 nm				
MAINS SUPPLY		100V - 240V 50 / 60 Hz (1 Phase + N) 250 VA		100V - 240V 50 / 60 Hz (1 Phase + N) 400 VA		100V - 240V 50 / 60 Hz (1 Phase + N) 300 VA		100V - 240V 50 / 60 Hz (1 Phase + N) 400 VA		
DIMENSIONS		Head				Rack				
		776x790x141 mm				601x190x141 mm				
WEIGHT		-				550x480.5x177 mm				
		Net weight: 18Kg Gross Weight: 20Kg				Net weight: 28Kg Gross Weight: 33Kg				
COOLING		Air								
SYSTEM		Resonator of the laser source, DACs board, drivers of the scanners, and galvanometric scanners built into the laser and marking head. Control and power electronics, Dual Processor CPU with 3 axis control and optoisolated Digital I/O, power supplies and laser source pumping unit built into the control rack.								
FOCAL SPECIFIC.	TECHNOLOGY			AB-N			AB-D			
	MA (mm)	WD (mm)	FL (mm)	D -	6	20	D -	6	10	20
	BD (μm)	PD (KW/ cm^2)	PD (KW/ cm^2)	BD (μm)	PD (KW/ cm^2)	PD (KW/ cm^2)	BD (μm)	PD (KW/ cm^2)	PD (KW/ cm^2)	PD (KW/ cm^2)
	55x55	141	100	27	2089	6964	16	5825	9709	19417
	100x100	205	163	44	796	2653	26	2192	3654	7308
	168x168	347	254	69	324	1079	41	903	1505	3009
	212x212	458	346	94	175	582	56	487	811	1622
	242x242	554	420	-	-	-	68	330	551	1101
500x500	889	815	-	-	-	132	88	146	292	
SOFTWARE OPTIONS		<ul style="list-style-type: none"> Abmarca label design software. Requires MS Windows 7 or higher AbOptima supervisory software Abvision control software for vision systems 								
USER INTERFACE		<ul style="list-style-type: none"> Touch Screen. Hand Held Terminal. PC / Laptop 								
LASER SOURCE		<ul style="list-style-type: none"> End pumped Nd:YAG resonator by an optical fiber. Beam pointer (optional red diode). 								
ACCESSORIES		Handheld Terminal-Touch Screen Terminal - Beam pointer - Encoder Kit - Photocell Kit - Alarm Kit Fume Extractor - Mounting support - Mounting Bracket U-ARM - Marking paper - Protection goggles - Air Cooling Kit - Water Cooling Kit (only for UV)								
ENVIRONMENTAL CONDITIONS		+15°C (59°F) at 40°C (104°F) external temperature with 50% Duty Cycle or 36°C(100°F) external temperature with 100% Duty Cycle. Humidity between 10% and 95%, without condensation. UV working humidity: 30-80%. No vibrations.								

* **MA:** Marking Area | **FL:** Focal Length (The distance between the center of the lens and the surface to be marked.)

WD: Working Distance (The distance between the laser system base and the surface to be marked.)

BD: Spot Beam Diameter | **PD:** Power Density

These values are an approximation, and they are different for each laser system, due to the different optical paths.

